

Brake Hoses

Chevrolet S10 1982-93 **GMC S15 Sonoma** 1982-93
Chevrolet Blazer 1983-94 **GMC Jimmy** 1983-94

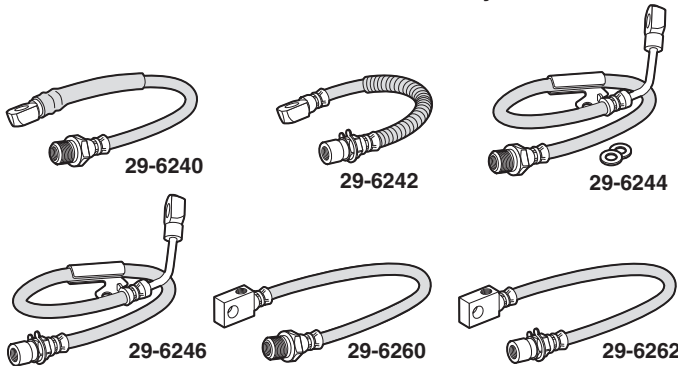

For 1991 there are two types of designs used to attach the brake hoses to the frame. Check your truck's current hoses before ordering to ensure you order the correct hoses.

1st Design: Hose screws to frame.

2nd Design: Hose clips to frame.

PART	DESCRIPTION AND APPLICATION	REQD	LIST	SELL
Front Brake Hoses				
29-6240	FRONT BRAKE HOSE 1ST DESIGN 2WD	82-91 (2)	18.69	14.95
29-6242	FRONT BRAKE HOSE 2ND DESIGN 2WD	91-93 (2)	18.69	14.95
29-6244	FRONT BRAKE HOSE-LH 1ST DESIGN 4WD	83-91 (1)	21.19	16.95
29-6245	FRONT BRAKE HOSE-RH 1ST DESIGN 4WD	83-91 (1)	21.19	16.95
29-6246	FRONT BRAKE HOSE-LH 2ND DESIGN 4WD	91-93 (1)	21.19	16.95
29-6247	FRONT BRAKE HOSE-RH 2ND DESIGN 4WD	91-93 (1)	21.19	16.95
Rear Brake Hoses				
29-6260	REAR BRAKE HOSE 1ST DESIGN CHEVY GMC	82-91 (1)	21.19	16.95
29-6262	REAR BRAKE HOSE 2ND DESIGN CHEVY GMC	91-93 (1)	21.19	16.95

Pre-Bent Stainless Steel Brake Line Kits

Chevrolet S10 1982-93 **GMC S15 Sonoma** 1982-93
Chevrolet Blazer 1983-94 **GMC Jimmy** 1983-94
With Power Brakes

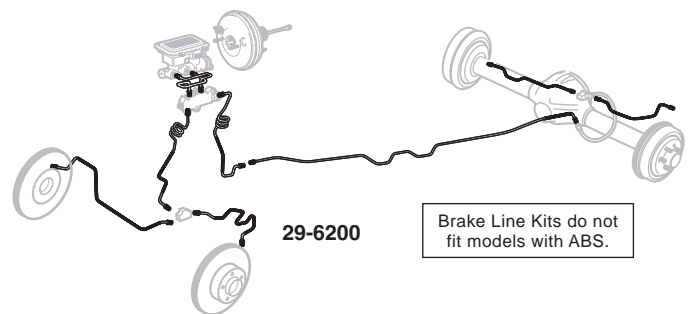

PART	DESCRIPTION AND APPLICATION	REQD	LIST	SELL
29-6200	BRAKE LINE KIT-STD CAB 2WD SHORTBED	82-88 (1)	287.44	229.95
29-6201	BRAKE LINE KIT-STD CAB 2WD LONGBED	82-88 (1)	287.44	229.95
29-6201	BRAKE LINE KIT-EXT CAB 2WD SHORTBED	82-88 (1)	287.44	229.95
29-6203	BRAKE LINE KIT-STD CAB 2WD SHORTBED	89-93 (1)	287.44	229.95
29-6204	BRAKE LINE KIT-STD CAB 2WD LONGBED	89-93 (1)	287.44	229.95
29-6204	BRAKE LINE KIT-EXT CAB 2WD SHORTBED	89-93 (1)	287.44	229.95
29-6212	BRAKE LINE KIT 2WD BLZ JIM	83-88 (1)	287.44	229.95
29-6213	BRAKE LINE KIT 2WD BLZ JIM	89-94 (1)	287.44	229.95
29-6206	BRAKE LINE KIT-STD CAB 4WD SHORTBED	83-88 (1)	287.44	229.95
29-6208	BRAKE LINE KIT-STD CAB 4WD LONGBED	83-88 (1)	287.44	229.95
29-6208	BRAKE LINE KIT-EXT CAB 4WD SHORTBED	83-88 (1)	287.44	229.95
29-6209	BRAKE LINE KIT-STD CAB 4WD SHORTBED	89-93 (1)	287.44	229.95
29-6211	BRAKE LINE KIT-STD CAB 4WD LONGBED	89-93 (1)	287.44	229.95
29-6211	BRAKE LINE KIT-EXT CAB 4WD SHORTBED	89-93 (1)	287.44	229.95
29-6214	BRAKE LINE KIT 4WD BLZ JIM	83-88 (1)	287.44	229.95
29-6215	BRAKE LINE KIT 4WD BLZ JIM	89-94 (1)	287.44	229.95

Brake and Clutch Fluids Meet Your Safety Standards

Castrol Brake and Clutch Fluid exceeds DOT 3 and DOT 4 specifications and is recommended for all vehicles with these requirements. Unique formulation provides maximum protection against vapor lock failure. Available in a 12-ounce bottle.

Silicone Brake and Clutch Fluid meets DOT 5 requirements and is best for extended use; it won't absorb water that can cause corrosion. Silicone Brake Fluid will not harm painted surfaces. Available in a 32-ounce bottle. **Not compatible with DOT 3 or DOT 4 brake fluid. Not for use in vehicles equipped with ABS.**



38-0785	CASTROL BRAKE/CLUTCH FLUID	DOT 3	4.94	3.95
38-0787	SILICONE BRAKE/CLUTCH FLUID	DOT 4	31.19	24.95
		DOT 5		

Brake Master Cylinder and Power Brake Booster

Chevrolet S10 1982-93 **GMC S15 Sonoma** 1982-93
Chevrolet Blazer 1983-94 **GMC Jimmy** 1983-94

How to Identify Your 1988-1993 Power Brake Booster:
 1988-93 models have a sticker affixed to the front of the booster housing. The sticker has two letters printed on it that are referred to as the stamped letters. Please order by matching the letters on your power brake booster with the correct part number.

Where to Find Production Option Label: The service parts identification label, located in the glove box, lists all production options for your vehicle. The options are represented by three character codes printed in alphabetical then numeric order.

Core Refund Information - Brake Booster: A rebuildable core will have no excessive wear. No broken, cracked or dented housings. No worn or stripped threads. If it does not meet the above standards, it is not rebuildable and will not be refunded. DO NOT send a non-rebuildable core.

W/POWER = Vehicles with Power Brakes		W/O POWER = Vehicles without Power Brakes	
29-6310	(1) MASTER CYLINDER	W/O POWER CHEVY GMC	82-88 (1) 112.44 89.95
29-6312	MASTER CYLINDER	W/POWER CHEVY GMC	83-93 (1) 99.94 79.95

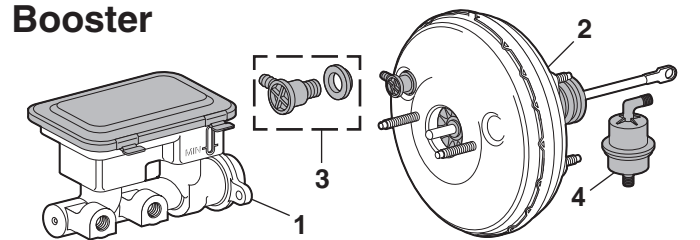

PART	ILL#	DESCRIPTION AND APPLICATION	REQD	LIST	SELL
29-6350-Z	(2)	BRAKE BOOSTER \$15 CORE "A" CHEVY GMC	82-93 (1)	124.94	99.95
29-6352-Z		BRAKE BOOSTER \$25 CORE "B" CHEVY GMC	82-93 (1)	149.94	119.95
29-6354-Z		BRAKE BOOSTER \$25 CORE "C" CHEVY GMC	88-93 (1)	137.44	109.95
34-4310	(3)	CHECK VALVE-BOOSTER "A" "B" CHEVY GMC	82-93 (1)	8.69	6.95
34-4309	(4)	AIR FILTER-BOOSTER	CHEVY GMC 82-87 (1)	16.19	12.95

Note: "A" Original booster stamped ZT - production option JM7.
 "B" Original booster stamped YC - production option JM5.
 "C" Original booster stamped ST - production option JM3.

Front Disc Brake Components

Chevrolet S10 1982-93 GMC S15 Sonoma 1982-93
 Chevrolet Blazer 1983-94 GMC Jimmy 1983-94

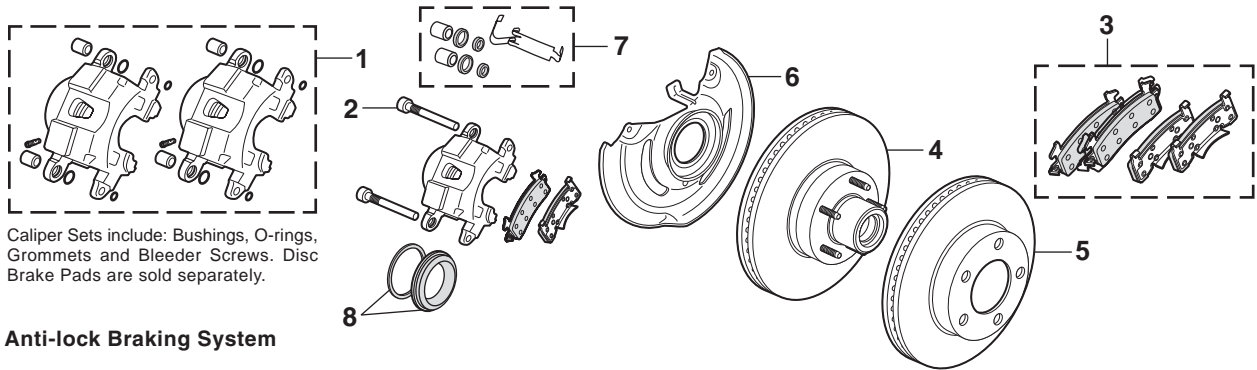

Caliper Sets include: Bushings, O-rings, Grommets and Bleeder Screws. Disc Brake Pads are sold separately.

ABS = Anti-lock Braking System

Core Refund Information - Calipers: A rebuildable core will have no excessive wear. Caliper must be assembled. No worn, damaged or cracked castings. No damaged bleeder screw threads or seat. No worn or elongated mounting points. If it does not meet the above standards, it is not rebuildable and will not be refunded. DO NOT send a non-rebuildable core.

PART	ILL#	DESCRIPTION AND APPLICATION	REQD	LIST	SELL
29-6610-Z	(1)	CALIPER SET-REMAN \$25 CORE 2WD	82-93 (1)	62.44	49.95
29-6612-Z		CALIPER SET-REMAN \$20 CORE 4WD	83-92 (1)	62.44	49.95
34-3671	(2)	CALIPER BOLT	CHEVY GMC 82-93 (4)	7.44	5.95
29-6450	(3)	DISC BRAKE PAD SET	CHEVY GMC 82-93 (1)	18.69	14.95
29-6510	(4)	BRAKE ROTOR W/O ABS 2WD	82-93 (2)	49.94	39.95
29-6510		BRAKE ROTOR W/REAR ABS 2WD	91-93 (2)	49.94	39.95
29-6512		BRAKE ROTOR W/4 WHEEL ABS 2WD	91-93 (2)	49.94	39.95
29-6514	(5)	BRAKE ROTOR 4WD	83-93 (2)	49.94	39.95

PART	ILL#	DESCRIPTION AND APPLICATION	REQD	LIST	SELL
29-6590	(6)	BRAKE SHIELD-LH 2WD PICKUP	82-93 (1)	31.19	24.95
29-6591		BRAKE SHIELD-RH 2WD PICKUP	82-93 (1)	31.19	24.95
29-6595		BRAKE SHIELD-RH 4WD PICKUP	90-93 (1)	87.44	69.95
29-6590		BRAKE SHIELD-LH 2WD BLZ JIM	83-90 (1)	31.19	24.95
29-6591		BRAKE SHIELD-RH 2WD BLZ JIM	83-90 (1)	31.19	24.95
29-6592		BRAKE SHIELD-LH 2WD BLZ JIM	91-94 (1)	74.94	59.95
29-6593		BRAKE SHIELD-RH 2WD BLZ JIM	91-94 (1)	74.94	59.95
29-6595		BRAKE SHIELD-RH 2DR 4WD BLZ JIM	90-91 (1)	87.44	69.95
29-6596		BRAKE SHIELD-LH 4DR 4WD BLZ JIM	91 (1)	174.94	139.95
29-6597		BRAKE SHIELD-RH 4DR 4WD BLZ JIM	91 (1)	174.94	139.95
29-6596		BRAKE SHIELD-LH 4WD BLZ JIM	92-94 (1)	174.94	139.95
29-6597		BRAKE SHIELD-RH 4WD BLZ JIM	92-94 (1)	174.94	139.95
29-6491	(7)	CALIPER HARDWARE KIT	CHEVY GMC 83-93 (1)	6.19	4.95
29-6492	(8)	CALIPER REPAIR KIT	CHEVY GMC 82-93 (2)	6.19	4.95

Rear Drum Brake Components

Chevrolet S10 1982-93 GMC S15 Sonoma 1982-93
 Chevrolet Blazer 1983-94 GMC Jimmy 1983-94

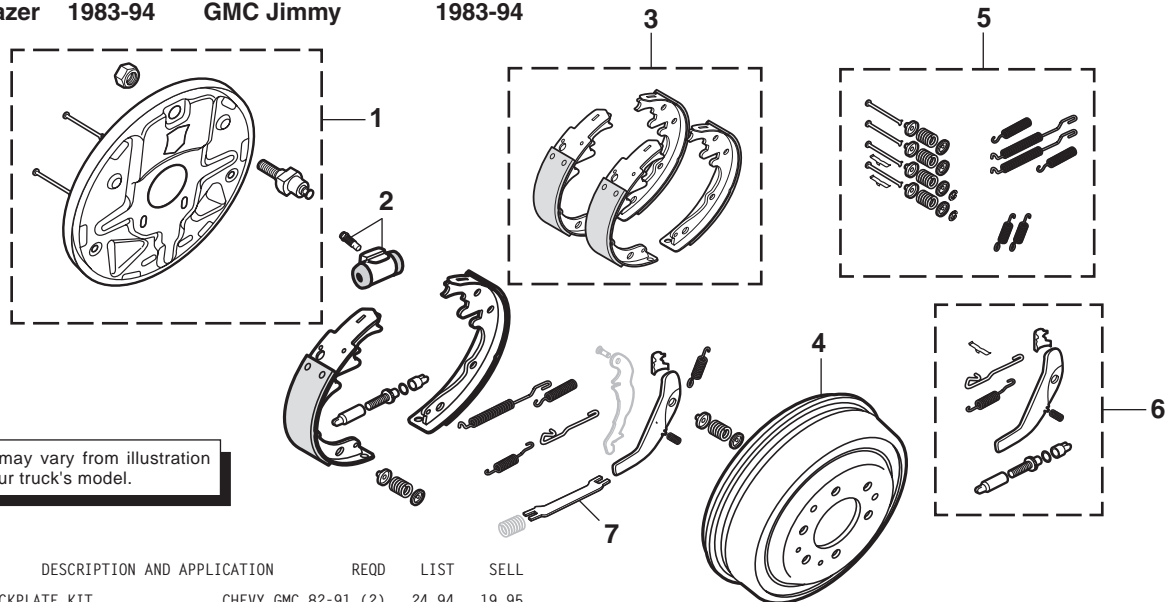

Kit components may vary from illustration depending on your truck's model.

PART	ILL#	DESCRIPTION AND APPLICATION	REQD	LIST	SELL
29-6488	(1)	BACKPLATE KIT	CHEVY GMC 82-91 (2)	24.94	19.95
29-6420	(2)	REAR WHEEL CYL W/O POWER	CHEVY GMC 82-89 (2)	37.44	29.95
29-6422		REAR WHEEL CYLINDER W/POWER	CHEVY GMC 83-91 (2)	37.44	29.95
29-6424		REAR WHEEL CYLINDER	CHEVY GMC 92-93 (2)	37.44	29.95
29-6460-R	(3)	SHOE SET-REMAN	CHEVY GMC 82-93 (1)	24.94	19.95
29-6522	(4)	REAR BRAKE DRUM	CHEVY GMC 82-91 (2)	49.94	39.95
29-6520		REAR BRAKE DRUM	CHEVY GMC 92-93 (2)	49.94	39.95
29-6470	(5)	BRAKE HARDWARE KIT	CHEVY GMC 82-93 (1)	8.69	6.95

PART	ILL#	DESCRIPTION AND APPLICATION	REQD	LIST	SELL
29-6472	(6)	SELF ADJUSTER KIT-LH	CHEVY GMC 82-83 (1)	22.44	17.95
29-6471		SELF ADJUSTER KIT-RH	CHEVY GMC 82-83 (1)	22.44	17.95
29-6474		SELF ADJUSTER KIT-LH	CHEVY GMC 84 (1)	21.19	16.95
29-6473		SELF ADJUSTER KIT-RH	CHEVY GMC 84 (1)	21.19	16.95
29-6476		SELF ADJUSTER KIT-LH	CHEVY GMC 85-93 (1)	21.19	16.95
29-6475		SELF ADJUSTER KIT-RH	CHEVY GMC 85-93 (1)	21.19	16.95
29-6489	(7)	PARK BRAKE LEVER	CHEVY GMC 82-93 (2)	12.44	9.95

Stainless Steel Brake Hose Kit



29-6290

Brake Hose Kits feature stainless steel braided hose with zinc-plated fittings, factory assembled for installation convenience. Stainless steel brake hoses increase braking performance and reduce brake pedal travel by eliminating hose expansion common to factory rubber hoses. Each kit comes with all necessary hardware and fittings.

For 1991 there are two types of designs used to attach the brake hoses to the frame. Check your truck's current hoses before ordering to ensure you order the correct hoses.

1st Design: Hose screws to frame.

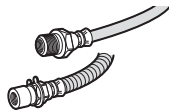

2nd Design: Hose clips to frame.

PART	DESCRIPTION AND APPLICATION	REQD	LIST	SELL
29-6290	SS STEEL BRAKE HOSE KIT 1ST 2WD PICKUP	82-91 (1)	124.94	99.95
29-6291	SS STEEL BRAKE HOSE KIT 2ND 2WD PICKUP	91-98 (1)	124.94	99.95
29-6292	SS STEEL BRAKE HOSE KIT 1ST 4WD PICKUP	83-91 (1)	137.44	109.95
29-6293	SS STEEL BRAKE HOSE KIT 2ND 4WD PICKUP	91-96 (1)	124.94	99.95
29-6290	SS STEEL BRAKE HOSE KIT 1ST 2WD BLZ JIM	83-91 (1)	124.94	99.95
29-6291	SS STEEL BRAKE HOSE KIT 2ND 2WD BLZ JIM	91-96 (1)	124.94	99.95
29-6292	SS STEEL BRAKE HOSE KIT 4WD 1ST BLZ JIM	83-91 (1)	137.44	109.95
29-6293	SS STEEL BRAKE HOSE KIT 4WD 2ND BLZ JIM	91-96 (1)	124.94	99.95

Front Slotted Cross Drilled Rotors



29-6560

Increase the braking ability of your truck by installing Slotted Cross Drilled Rotors. Performance brake rotors provide shorter stopping distances, lessen fade and improve wet-weather braking. Chamfered cross drilled holes allow built-up heat and gasses to dissipate, lowering rotor temperature by up to 200°, prolonging rotor and pad life. The curved slots deglaze the brake pads, reduce brake fade and minimize brake dust. The rotors are CNC machined and feature a silver zinc coating to protect against corrosion.

PART	DESCRIPTION AND APPLICATION	REQD	LIST	SELL
29-6560	SLOTTED/DRILLED ROTOR SET"A" 2WD PICKUP	82-95 (1)	224.94	179.95
29-6561	SLOTTED/DRILLED ROTOR SET"B" 2WD PICKUP	91-03 (1)	237.44	189.95
29-6562	SLOTTED/DRILLED ROTOR SET"C" 4WD PICKUP	83-97 (1)	199.94	159.95
29-6563	SLOTTED/DRILLED ROTOR SET"D" 4WD PICKUP	98-04 (1)	212.44	169.95
29-6560	SLOTTED/DRILLED ROTOR SET"A" 2WD BLZ JIM	83-95 (1)	224.94	179.95
29-6561	SLOTTED/DRILLED ROTOR SET"B" 2WD BLZ JIM	91-97 (1)	237.44	189.95
29-6563	SLOTTED/DRILLED ROTOR SET"D" 2WD BLZ JIM	98-05 (1)	212.44	169.95
29-6562	SLOTTED/DRILLED ROTOR SET"C" 4WD BLZ JIM	83-97 (1)	199.94	159.95
29-6563	SLOTTED/DRILLED ROTOR SET"D" 4WD BLZ JIM	97-05 (1)	212.44	169.95

Note: "A" Without 4-wheel ABS. "B" With 4-wheel ABS. "C" Models with rear drum brakes. "D" Models with rear disc brakes.

Performance Non-Asbestos Disc Pads

Extreme Performance Non-Asbestos Disc Brake Pads are proven performers that deliver the high braking performance you need on demand, under normal and rigorous driving conditions.



29-6455

29-6455	BRAKE PAD SET-FRONT	2WD PICKUP	82-03 (1)	62.44	49.95
29-6455	BRAKE PAD SET-FRT	W/RR DRUM 4WD PICKUP	83-97 (1)	62.44	49.95
29-6455	BRAKE PAD SET-FRONT	W/RR DRUM BLZ JIM	83-97 (1)	62.44	49.95

Disc Brake Proportion Valve

Chevrolet S10 1989-93 GMC S15 Sonoma 1989-93
Chevrolet Blazer 1989-94 GMC Jimmy 1989-94

The Proportion Valve helps prevent premature rear wheel slide by limiting the amount of increase in hydraulic pressure passed to the rear brakes. This prevents the rear brakes from locking up before the full effective braking effort is produced by the front disc brakes.

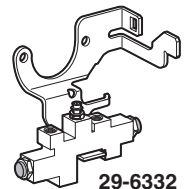

29-6332

PART	DESCRIPTION AND APPLICATION	REQD	LIST	SELL
29-6332	DISC BRAKE PROPORTION VALVE	CHEVY GMC 89-93 (1)	287.44	229.95

High Amp Alternators

Chevrolet S10 1982-04 GMC S15 Sonoma 1982-04
Chevrolet Blazer 1983-05 GMC Jimmy 1983-01

PART	DESCRIPTION AND APPLICATION	REQD	LIST	SELL
36-2725	ALTERNATOR-CHROME 100AMP 4CYL 6CYL	82-85 (1)	249.94	199.95
36-2727	ALTERNATOR 140AMP 4CYL 6CYL	82-85 (1)	274.94	219.95
36-2728	ALTERNATOR-CHROME 140AMP 4CYL 6CYL	82-85 (1)	399.94	319.95
36-2725	ALTERNATOR-CHROME 100AMP"A" 2.5L	86 (1)	249.94	199.95
36-2727	ALTERNATOR 140AMP"A" 2.5L	86 (1)	274.94	219.95
36-2728	ALTERNATOR-CHROME 140AMP"A" 2.5L	86 (1)	399.94	319.95
36-2735	ALTERNATOR-CHROME 105AMP"B" 2.5L 2.8L	86 (1)	324.94	259.95
36-2736	ALTERNATOR 140AMP"B" 2.5L 2.8L	86 (1)	287.44	229.95
36-2737	ALTERNATOR-CHROME 140AMP"B" 2.5L 2.8L	86 (1)	374.94	299.95
29-4327	ALTERNATOR-CHROME 105AMP 2.5L 2.8L 87-93 (1)	362.44	289.95	
29-4328	ALTERNATOR 140AMP 2.5L 2.8L 87-93 (1)	274.94	219.95	
29-4329	ALTERNATOR-CHROME 140AMP 2.5L 2.8L 87-93 (1)	349.94	279.95	

Note: "A" Alternator has two-terminal connector.
 "B" Alternator has four-terminal connector.
 "C" Does not fit 1996-02 models with 4.3L engine.

Do you need more amperage to run today's modern accessories? These high amp alternators will give your truck the charging power it needs. Direct replacement for your original alternator. Features include high output with excellent idle performance; hand wound, custom designed stators; gold-plated battery post for better electrical connections; and "Proof of Performance" tag.



36-2725

29-4331	ALTERNATOR-CHROME 105AMP"C" 2.2L 4.3L	94-03 (1)	374.94	299.95
29-4332	ALTERNATOR 150AMP"C" 2.2L 4.3L	94-03 (1)	374.94	299.95
29-4333	ALTERNATOR-CHROME 150AMP"C" 2.2L 4.3L	94-03 (1)	499.94	399.95
36-2729	ALTERNATOR-CHROME 105AMP 4.3L	87-93 (1)	324.94	259.95
36-2730	ALTERNATOR 140AMP 4.3L	87-93 (1)	287.44	229.95
36-2731	ALTERNATOR-CHROME 140AMP 4.3L	87-93 (1)	374.94	299.95
36-2738	ALTERNATOR-CHROME 105AMP 4.3L	96-97 (1)	412.44	329.95
36-2739	ALTERNATOR 150AMP 4.3L	96-97 (1)	399.94	319.95
36-2740	ALTERNATOR-CHROME 150AMP 4.3L	96-97 (1)	499.94	399.95
29-4324	ALTERNATOR-CHROME 105AMP 4.3L	98-04 (1)	399.94	319.95
29-4325	ALTERNATOR 150AMP 4.3L	98-04 (1)	399.94	319.95
29-4326	ALTERNATOR-CHROME 150AMP 4.3L	98-04 (1)	499.94	399.95